



DESOLINATION

**An innovative desalination concept
coupling concentrated solar for GCC
countries**

Frank Lipnizki

Kristofer Poirier, Kumar Patchigolla, Giampaolo Manzolini, Najah Al Mhanna

Oman Water Week

08/04/2025



- **Water Scarcity Crisis:** By 2030, 40% of the world's population could face water shortages. With only 3% of Earth's water being freshwater, efficient water use is crucial.
- **Solar Energy:** A key player in reducing carbon emissions, accounted for 11% of global renewable energy in 2019 and has grown by 16% since 2020.
- **DESOLINATION:** The project integrates concentrated solar power (CSP) with advanced membrane processes and zero-liquid discharge (ZLD) technology to create a sustainable, zero-carbon desalination system.



- **Integrated Membrane System:** Combines FO, NF, and MD with ZLD, including multi-crystallization for mineral recovery.
- **Advanced Membranes:** Develops and tests new membranes for FO, MD, and NF, exploring thermo-responsive polymers for FO.
- **Scaling Up:** The optimized system will be connected to the air Brayton cycle solar power tower at King Saud University, Saudi Arabia.

Overall process

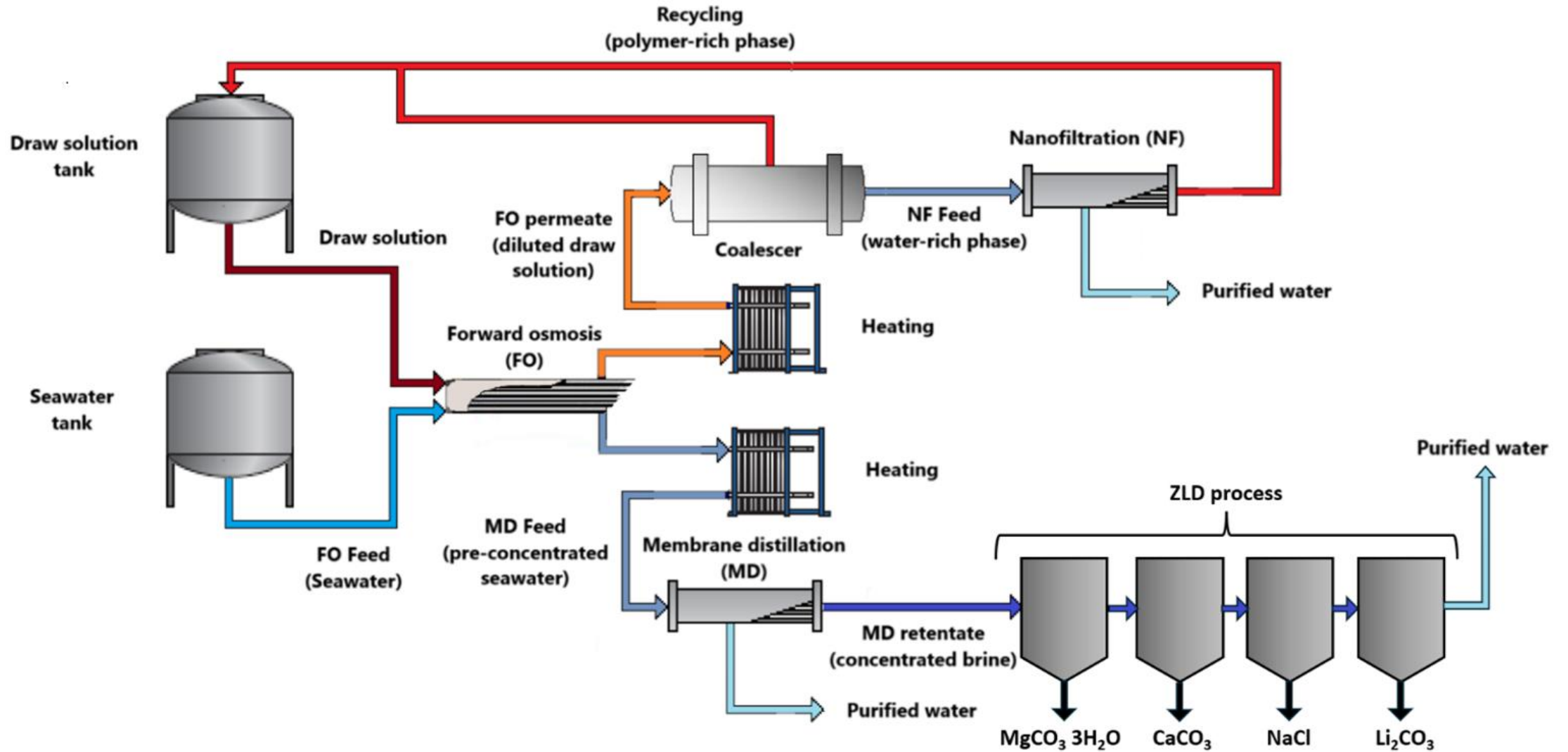

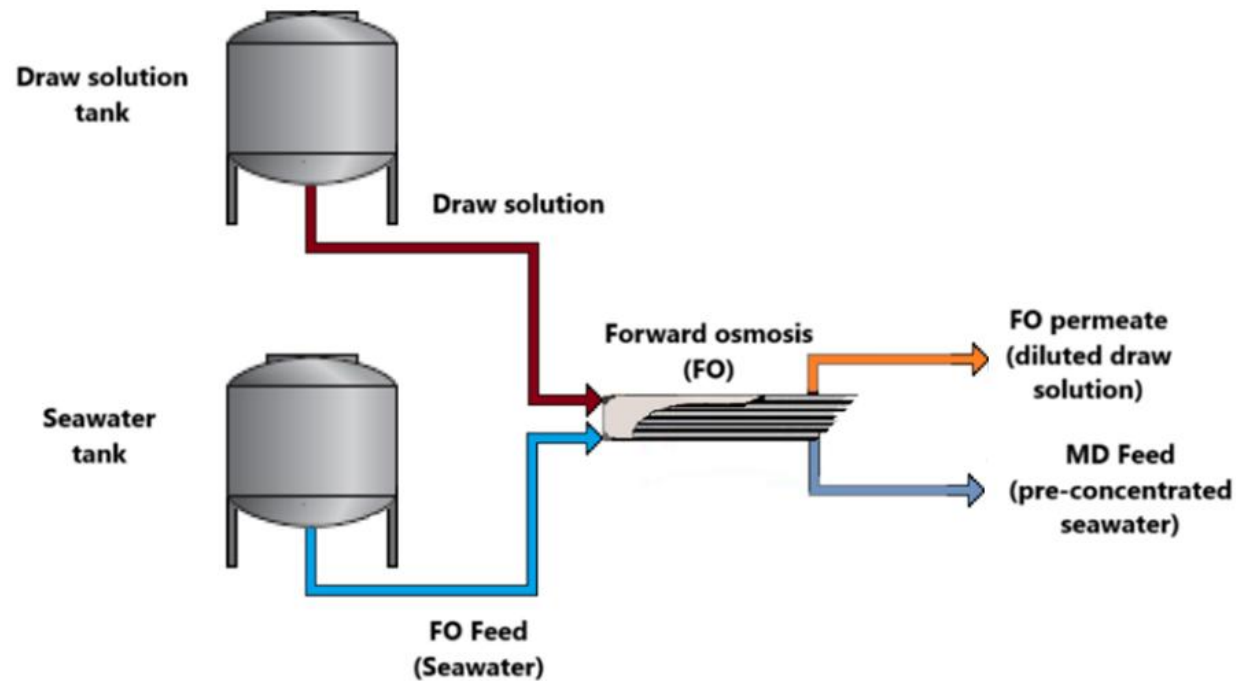

FO Membranes:

Two high-flux polymeric concepts under development:

- Electrospun PAN plus layer-by-layer technique.
- Electrospun PS plus TFC.

Draw Solution:

Thermo-responsive polymers are under investigation:

- Selection Criteria: Compatibility, viscosity, and osmotic pressure.

Selection of a Commercial membrane

	Aquaporin	Toyobo
Material	PA + Aquaporins	Cellulose triacetate
Type	Hollow fibre module	Hollow fibre module
Area (m ²)	2.3	31.5

	Draw (Unilube50MB-26)	Feed (NaCl)
Concentration	75 % w/w	3.5 % w/w
Mode of feed	Single pass	Circulating
Position of feed	Shell	Bore

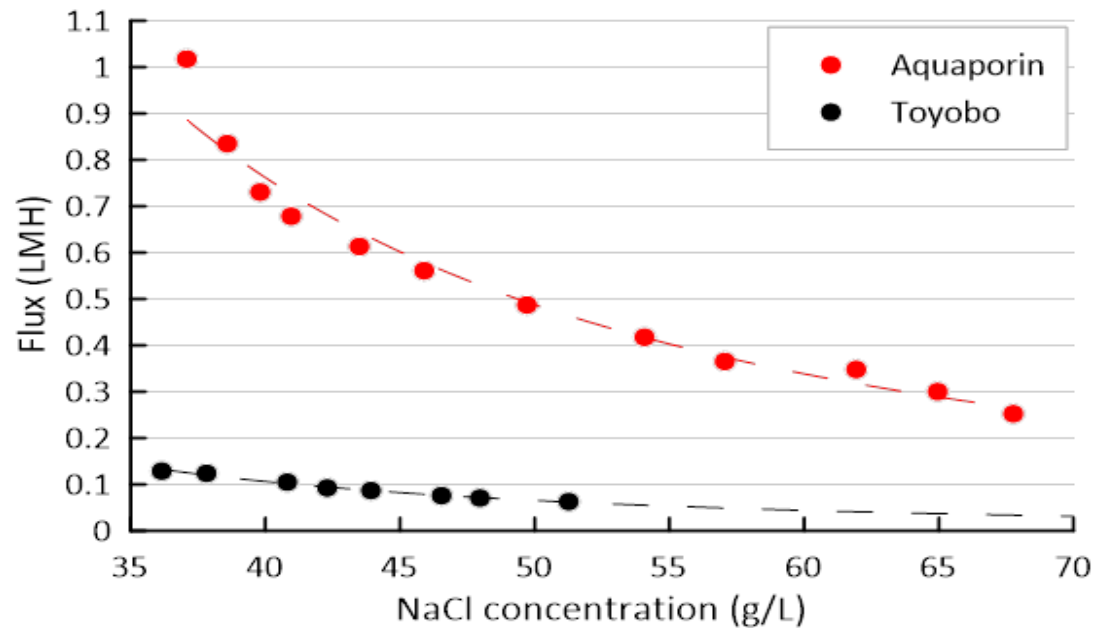

FO pilot unit (LUND)

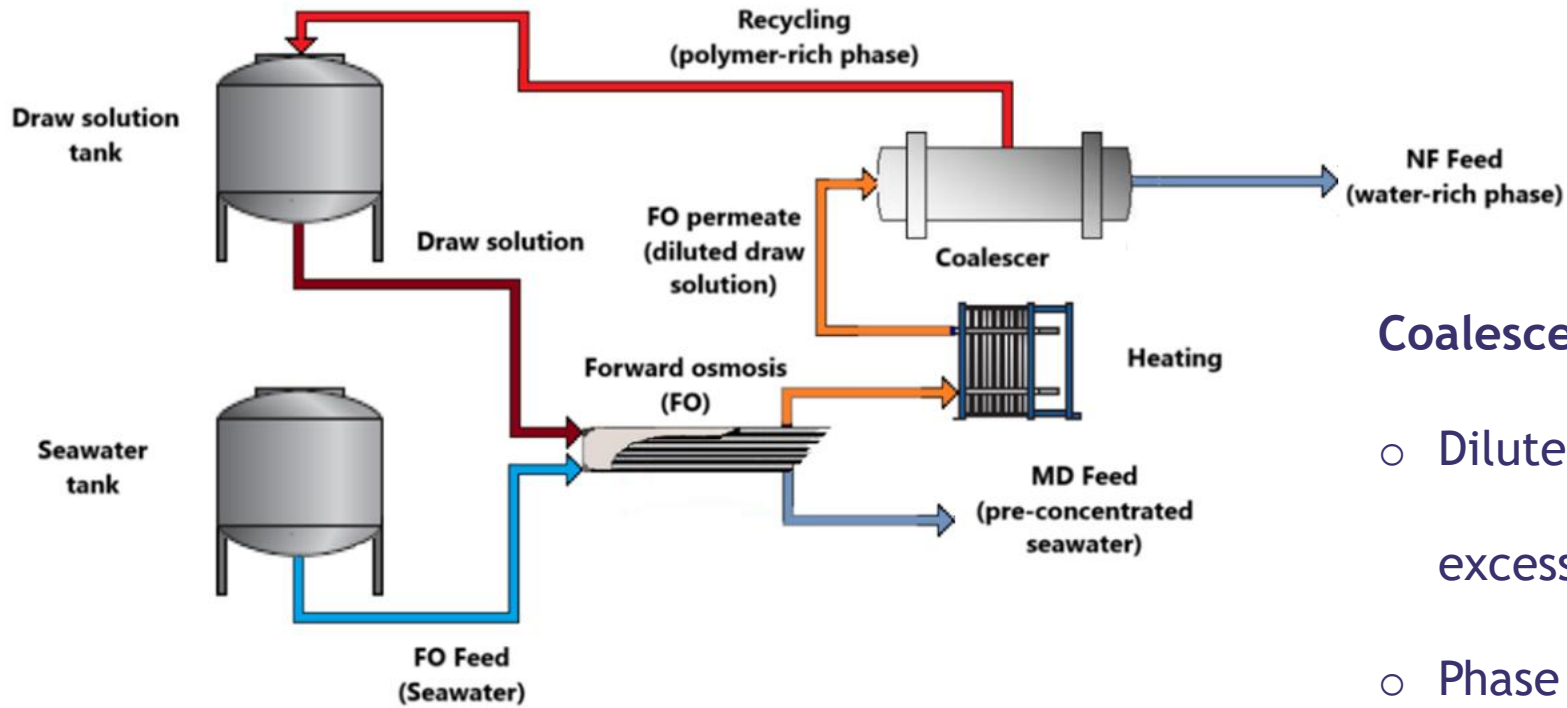

Coalescer:

- Diluted draw solution is heated using excess heat from the Brayton cycle.
- Phase separation in coalescer results in a polymer- and in a water-rich phase.

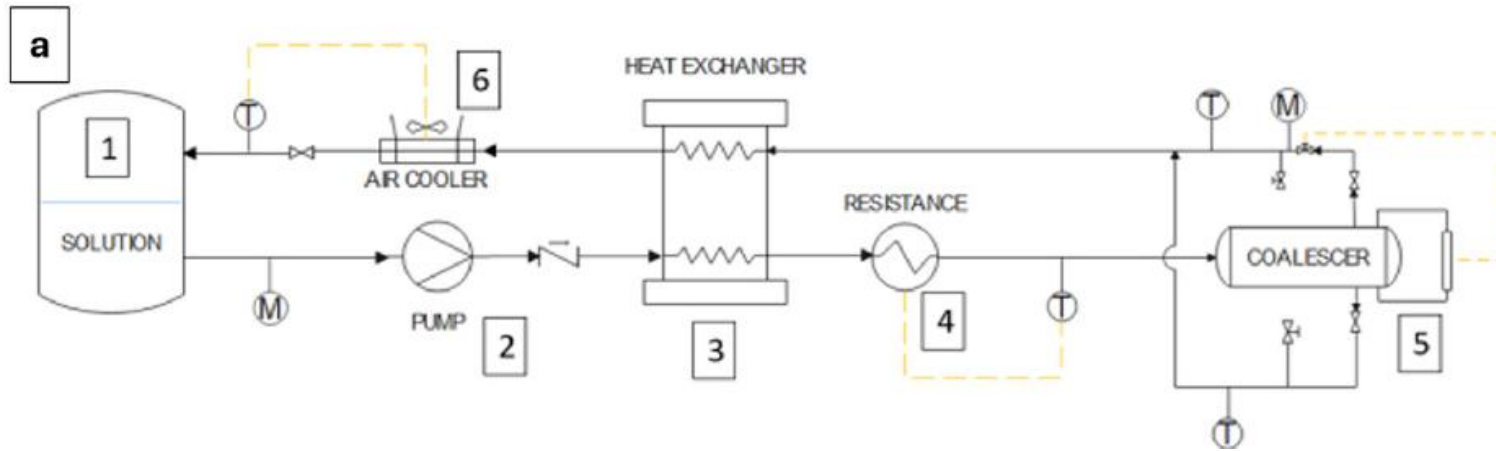

Coalescer pilot unit (Politecnico di Milano)

Optimisation of process conditions:
Concentration, temperature and flow rate.

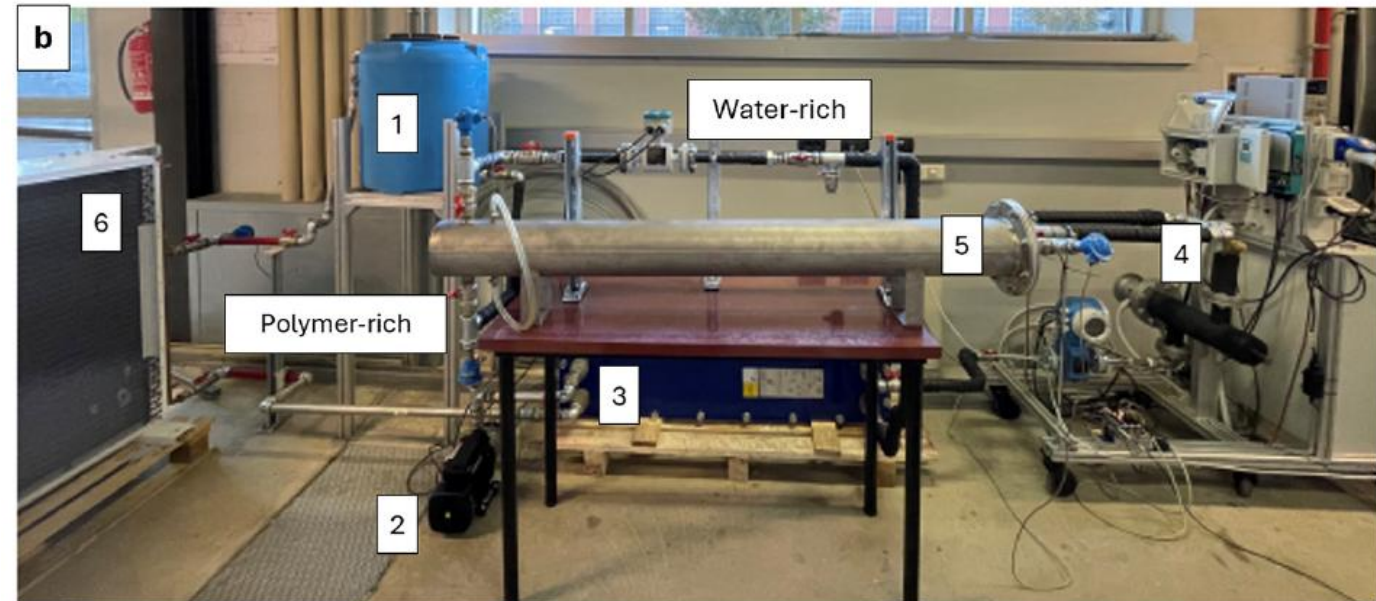

Source: Desalination Volume 5861 October 2024 Article number 117840

Lower Critical Solution Temperature (LCST) for PAGB2000

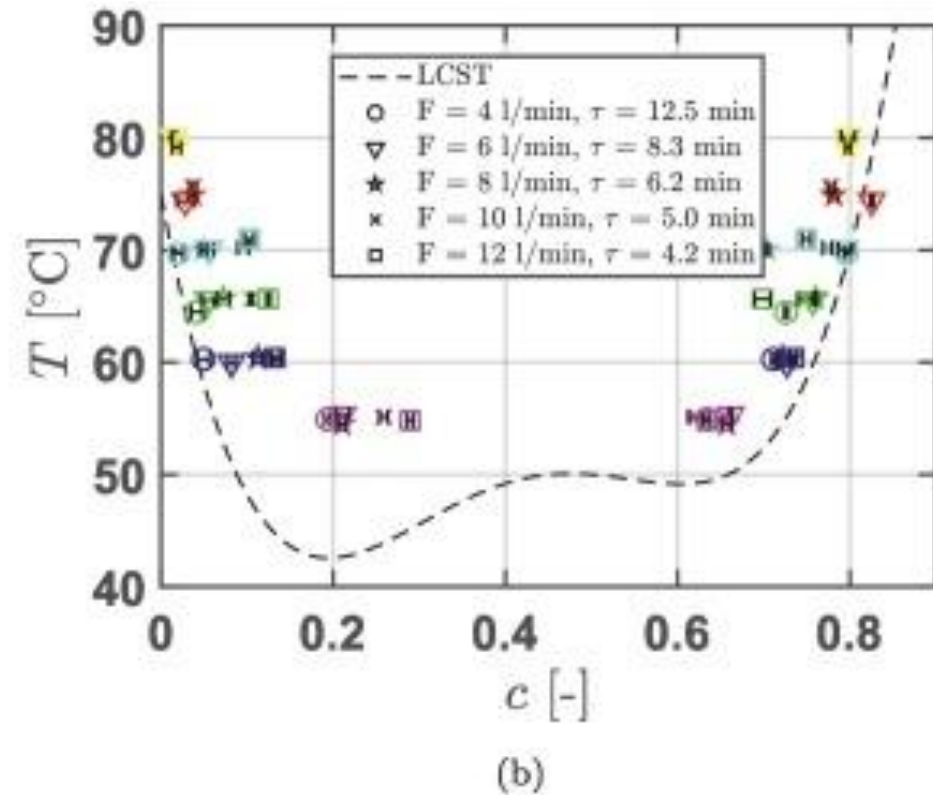
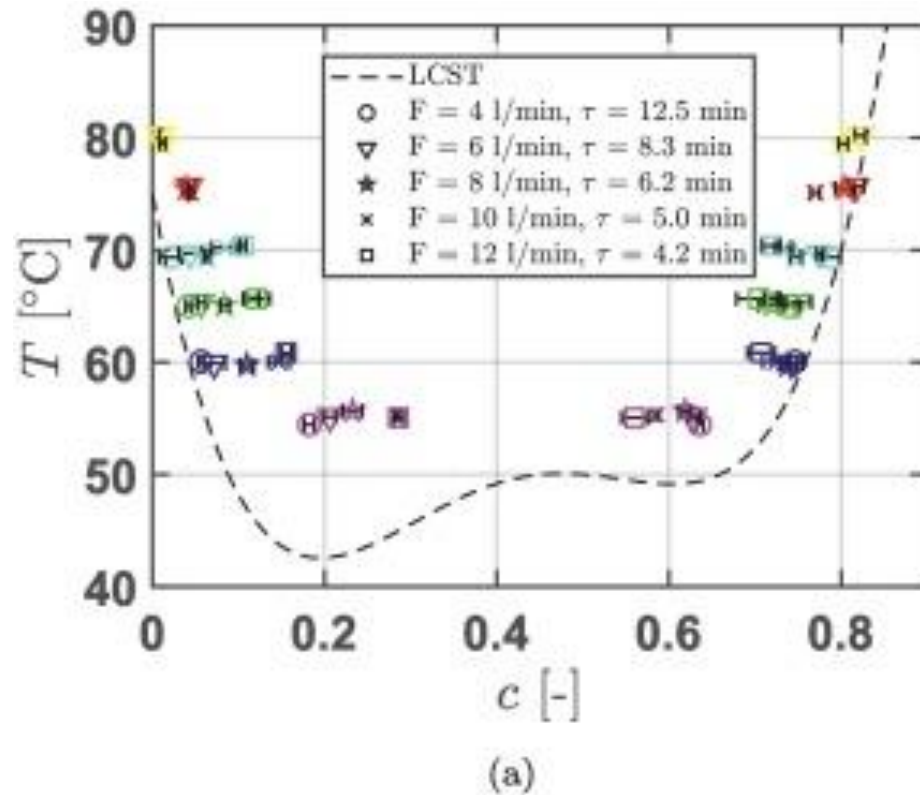

Influence of regeneration temperatures, residence time (τ), initial draw concentration: 0.50 (a) and 0.60 (b)

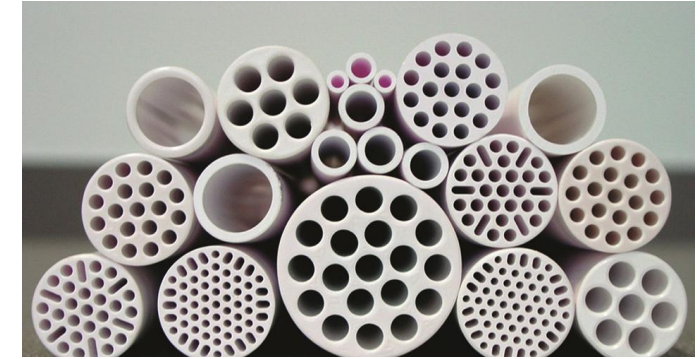
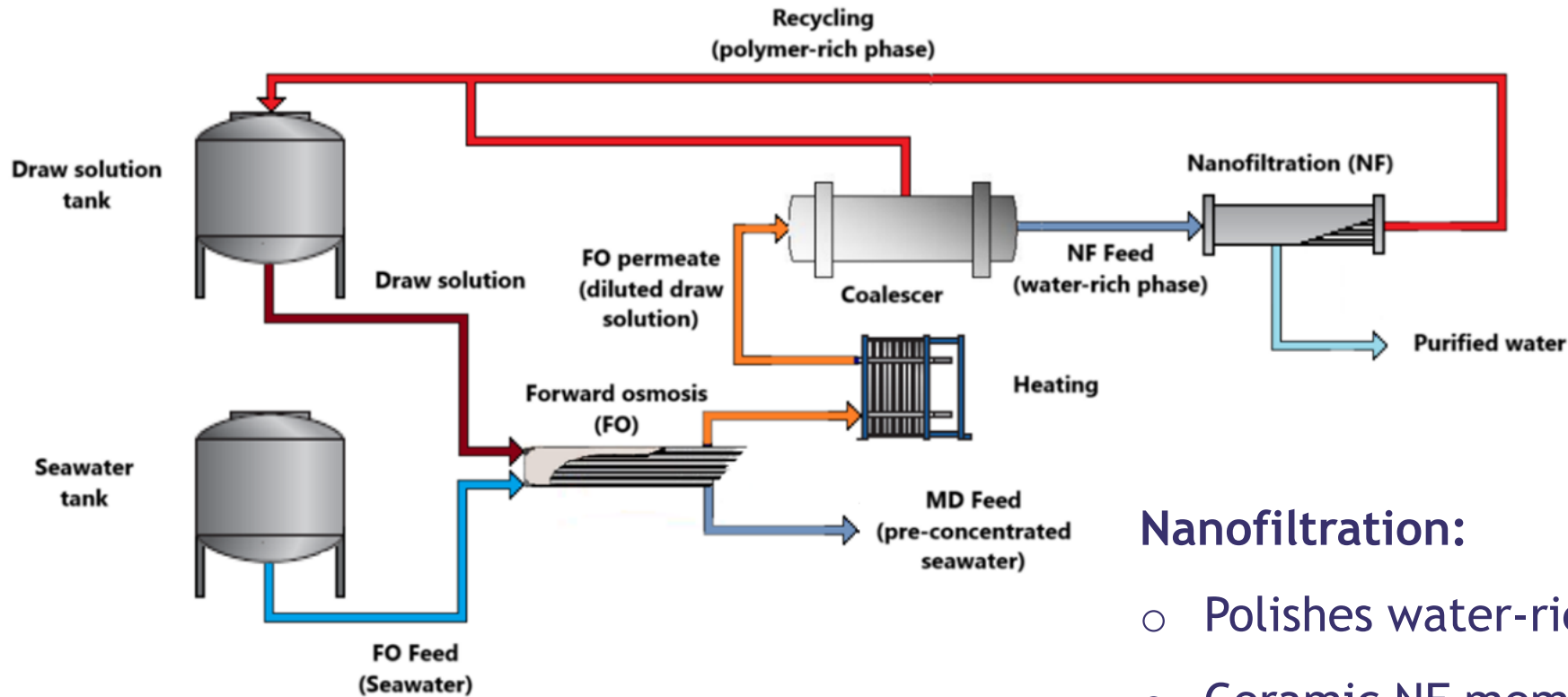

Different membrane geometries developed by IKTS.

Nanofiltration:

- Polishes water-rich phase from coalescer.
- Ceramic NF membranes from IKTS were chosen to reduce the need for cooling after the decantation process.

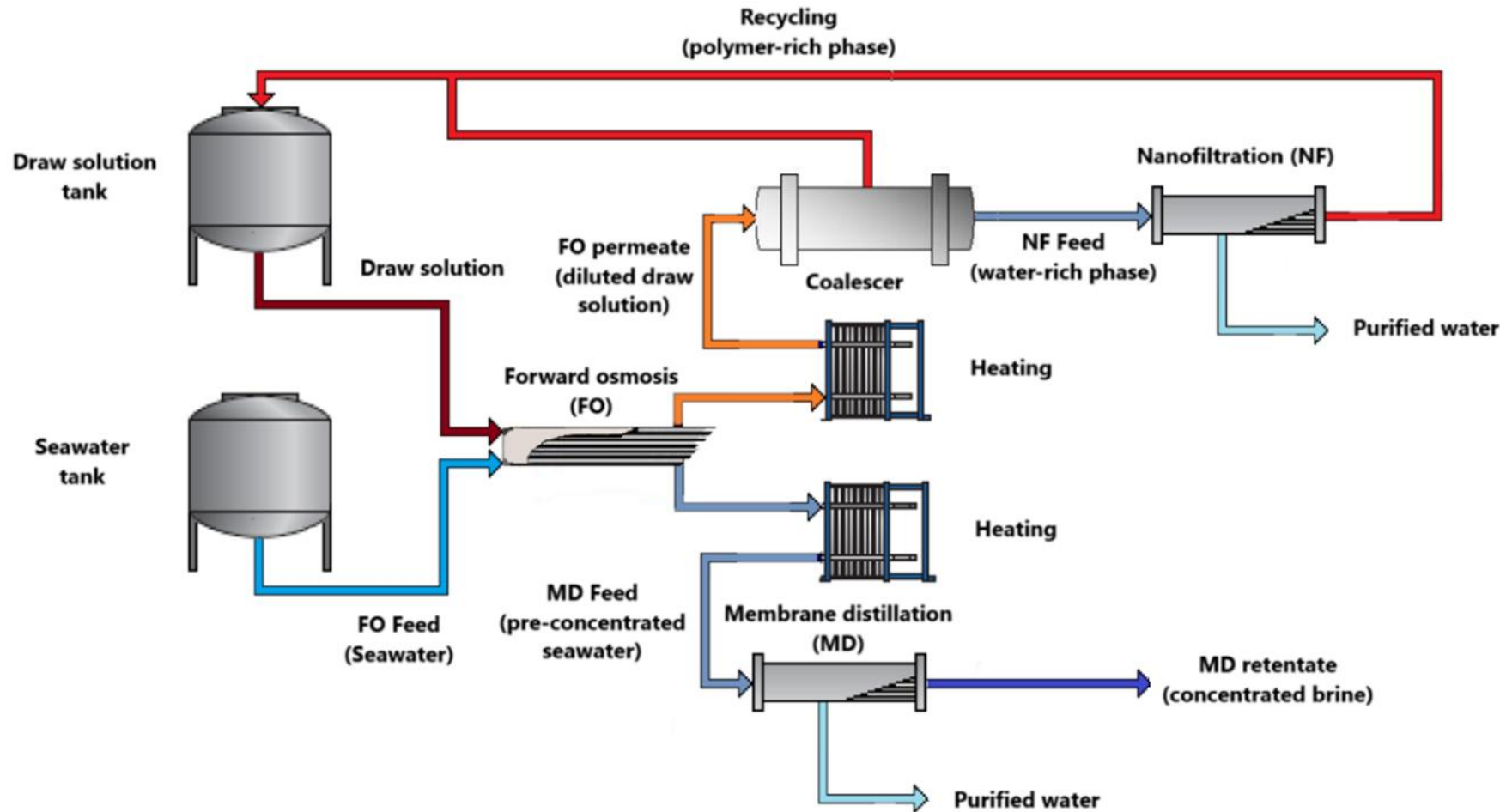

Membrane Distillation:

- Increase brine concentration and water recover.
- New superhydrophobic ceramic membranes for vacuum MD.
- Membranes use silane grafting.

Zero liquid discharge (ZLD)

Zero liquid discharge:
Multi-stage crystallizers to treat
the MD retentate.

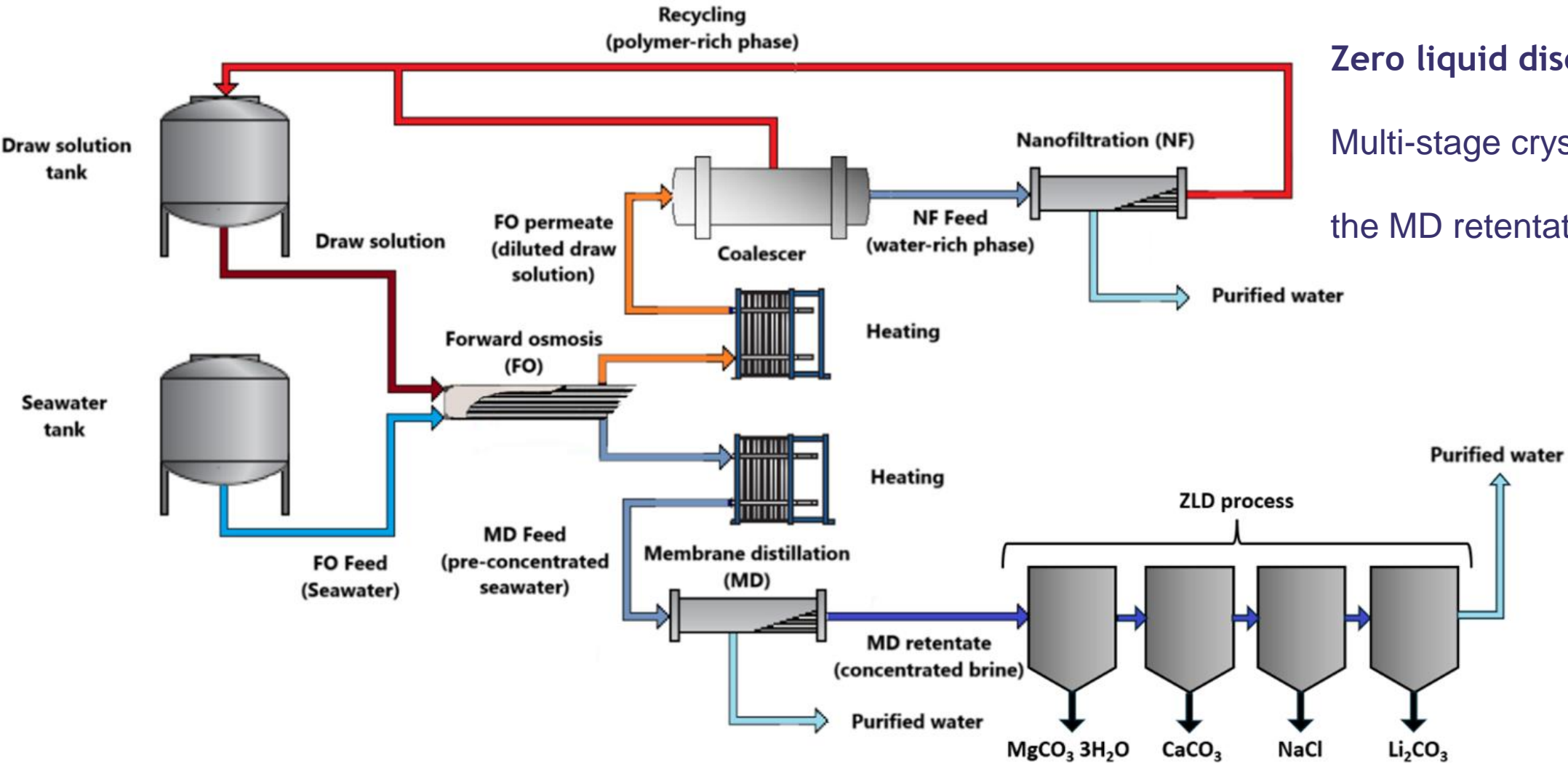



Brine mining

Simulations using Aspen Plus™ predict:

- Near 100% recovery of water from concentrated brines
- Recovery of:
 - 89% of Mg^{2+}
 - 99% of Ca^{2+}
 - 72% of NaCl
 - 80% of Li^+
- For each cubic meter of concentrated seawater brine, this ZLD method can produce:
 - 11.23 kg of $MgCO_3 \cdot 3H_2O$
 - 1.74 kg of $CaCO_3$
 - 29.64 kg of NaCl
 - 1.23 g of Li_2CO_3

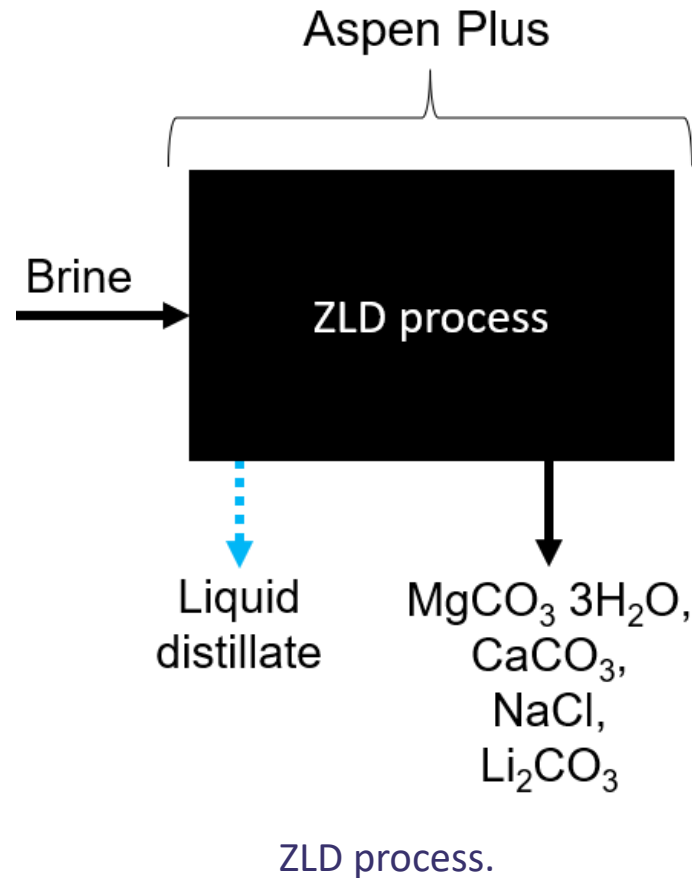

Is Brine Mining profitable?

Case study of Tenerife Island

- Model and simulate a large-scale sustainable MED desalination plant under three scenarios.
- 100,000 m³/day seawater feed.
- Calculate levelised cost of water and payback period with/without ZLD.
- Assess techno-economic benefits of brine mining.
- Compare with state-of-the-art and commercial data.

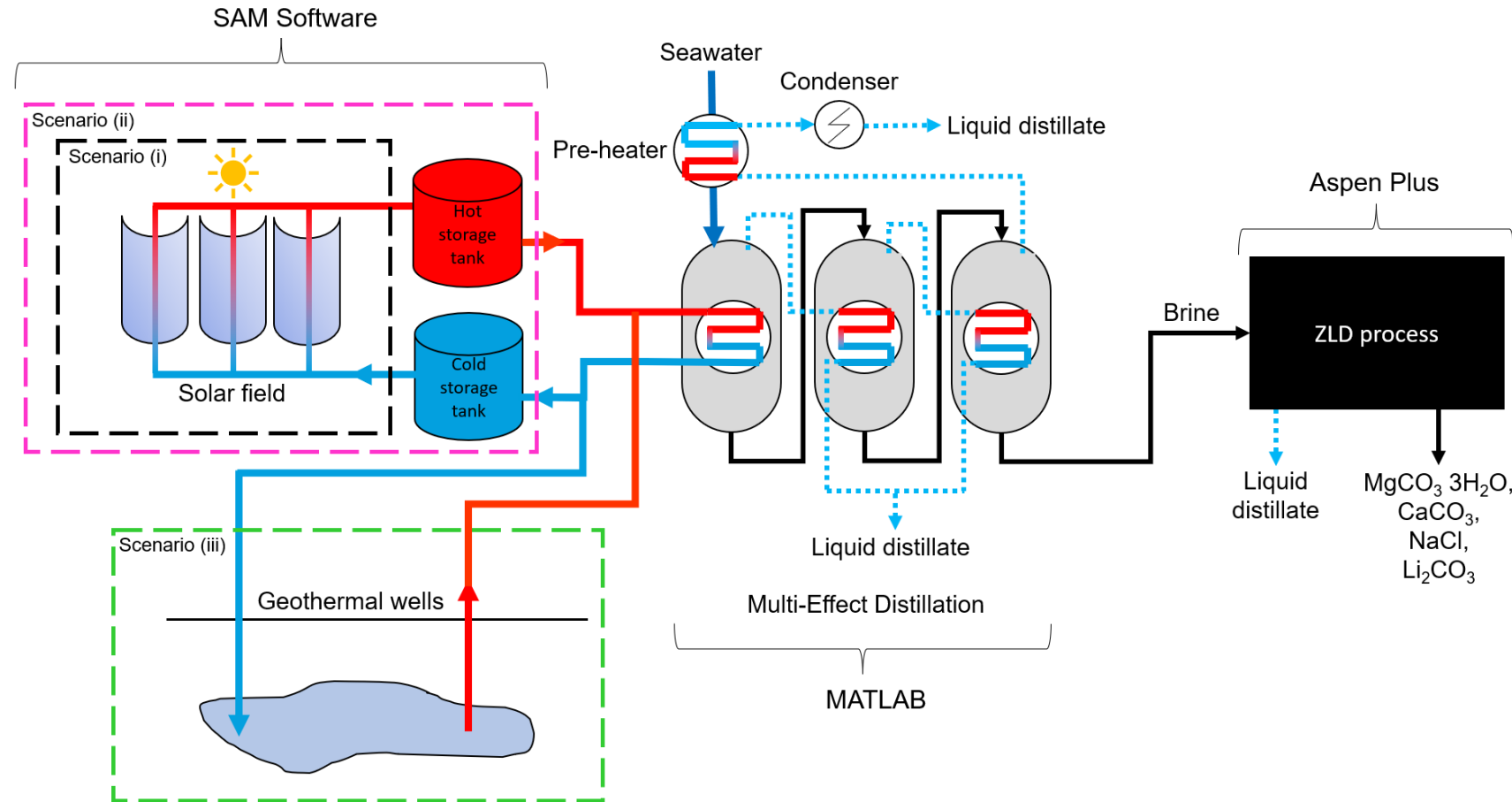

Integrated MED-ZLD model. Scenarios (i), (ii), and (iii) are represented within the black, pink, and green dotted boxes respectively.



Without ZLD	With ZLD
Water recovery = 40%	Water recovery = 99.8%
Levelised Cost of Water: <ul style="list-style-type: none"> • (i) 6.08 \$/m³ • (ii) 2.74 \$/m³ • (iii) 1.54 \$/m³ 	Levelised Cost of Water: <ul style="list-style-type: none"> • (i) 16.97 \$/m³ • (ii) 6.54 \$/m³ • (iii) 5.09 \$/m³
Payback period: <ul style="list-style-type: none"> • (i) Non-profitable • (ii) 13.2 years • (iii) 5.3 years 	Payback period: <ul style="list-style-type: none"> • (i) 24.0 years • (ii) 6.9 years (47.7% drop) • (iii) 4.7 years (11.3% drop)
	Annual expenses increased: <ul style="list-style-type: none"> • (i) by 6.7-times • (ii) by 5.8 times • (iii) by 8-times • <u>Revenue increased by 9.4-times in all cases</u> • CO₂ emissions reduced by 26k-124k tonnes/year <p>➡ Brine mining improves profitability and sustainability</p>



- **DESOLINATION** provides a sustainable solution to water scarcity by integrating solar power with advanced desalination technologies.
- **Innovative membrane development:** FO, MD, and NF membranes, along with thermo-responsive polymers, enhance water recovery and reduce environmental impact.
- **Zero-liquid discharge integration** enables valuable salt recovery and achieves nearly 100% water recovery.
- **Sustainable and cost-effective:** Offers a viable solution for clean water production, particularly in water-scarce regions like the Middle East.



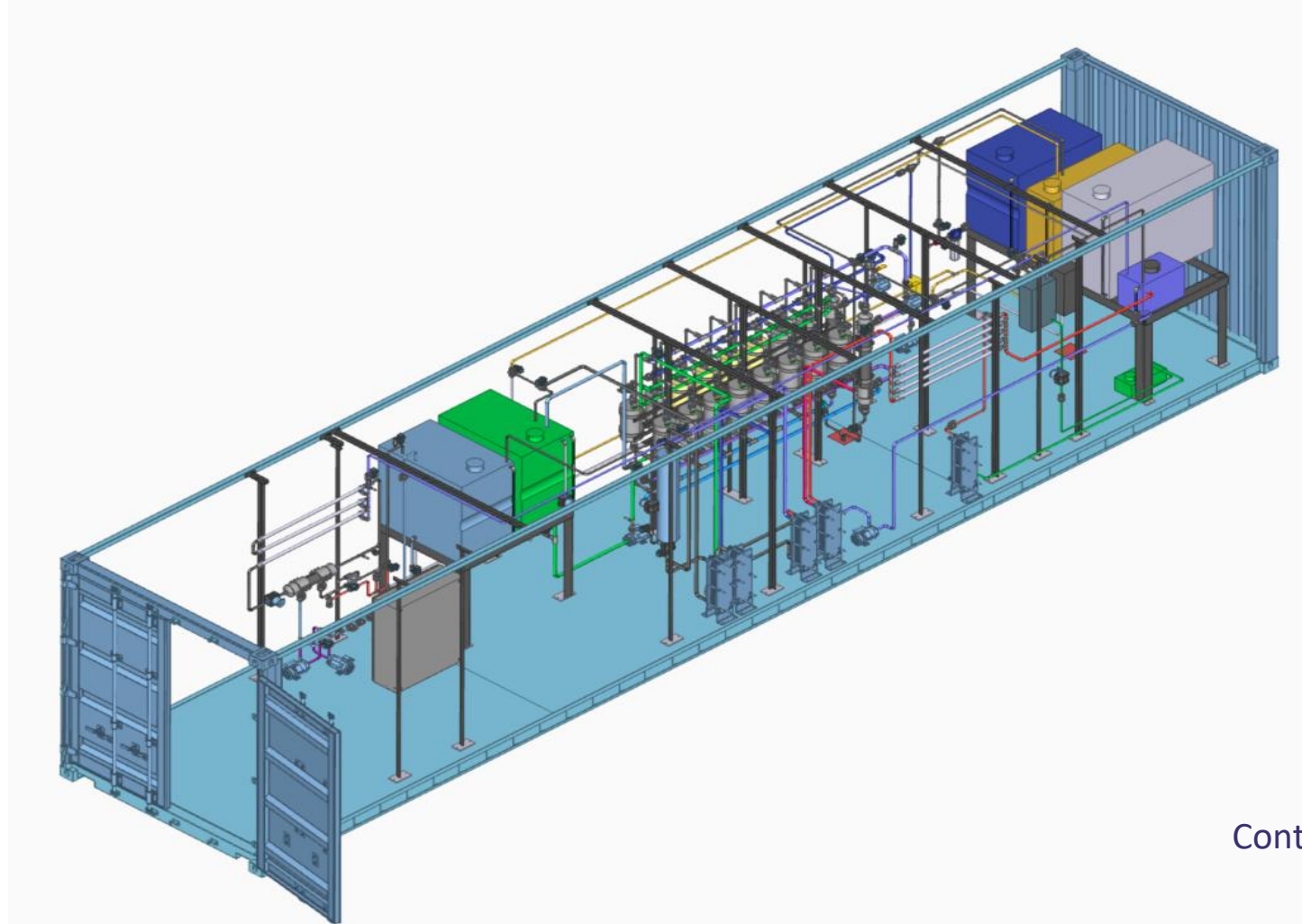

Container design (Protarget).

Large-scale pilot to be installed and started at King Saud University in Saudi Arabia in Sept 2025.





The DESOLINATION project has received funding from the European Union's Horizon 2020 research and innovation programme under grant agreement N° 101022686



Thank you for your attention.
Any questions?



Frank Lipnizki
Membrane Group, Lund University, Sweden
Email: frank.Lipnizki@ple.lth.se

